



Electrolux

Instruction Book

사용 설명서

Sách Hướng Dẫn

Buku Petunjuk

คู่มือการใช้งาน

Livre d'instructions

کتاب التعليمات

500 Bagless cleaner

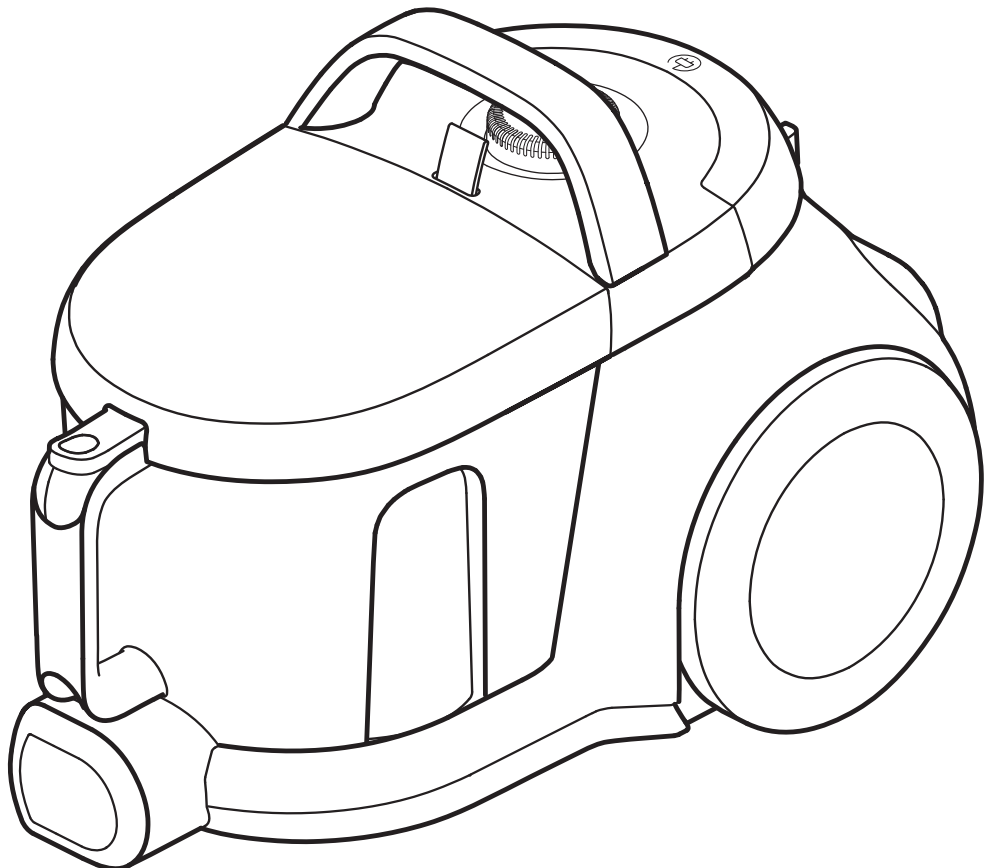

*Actual product may differ from illustration.

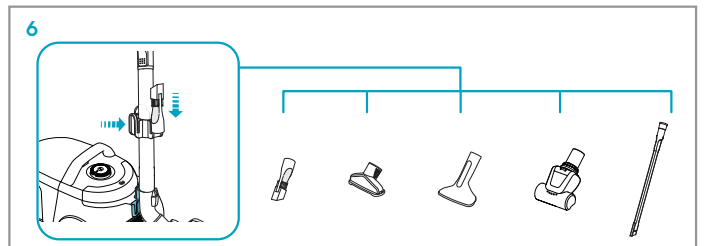
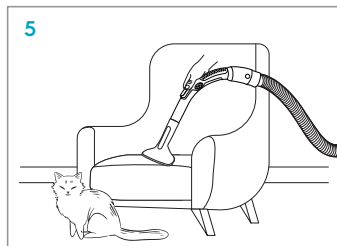
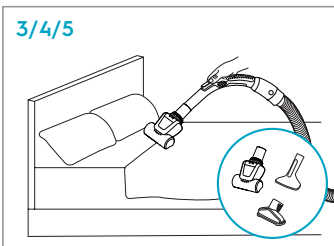
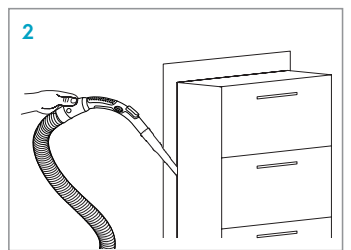
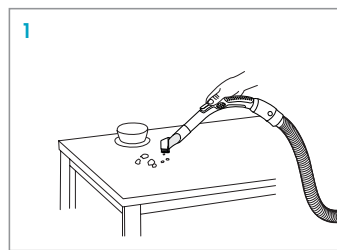
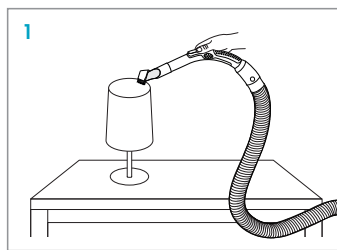
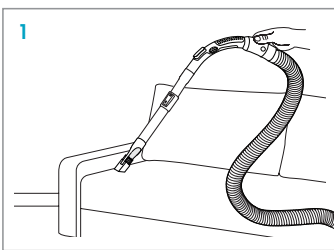
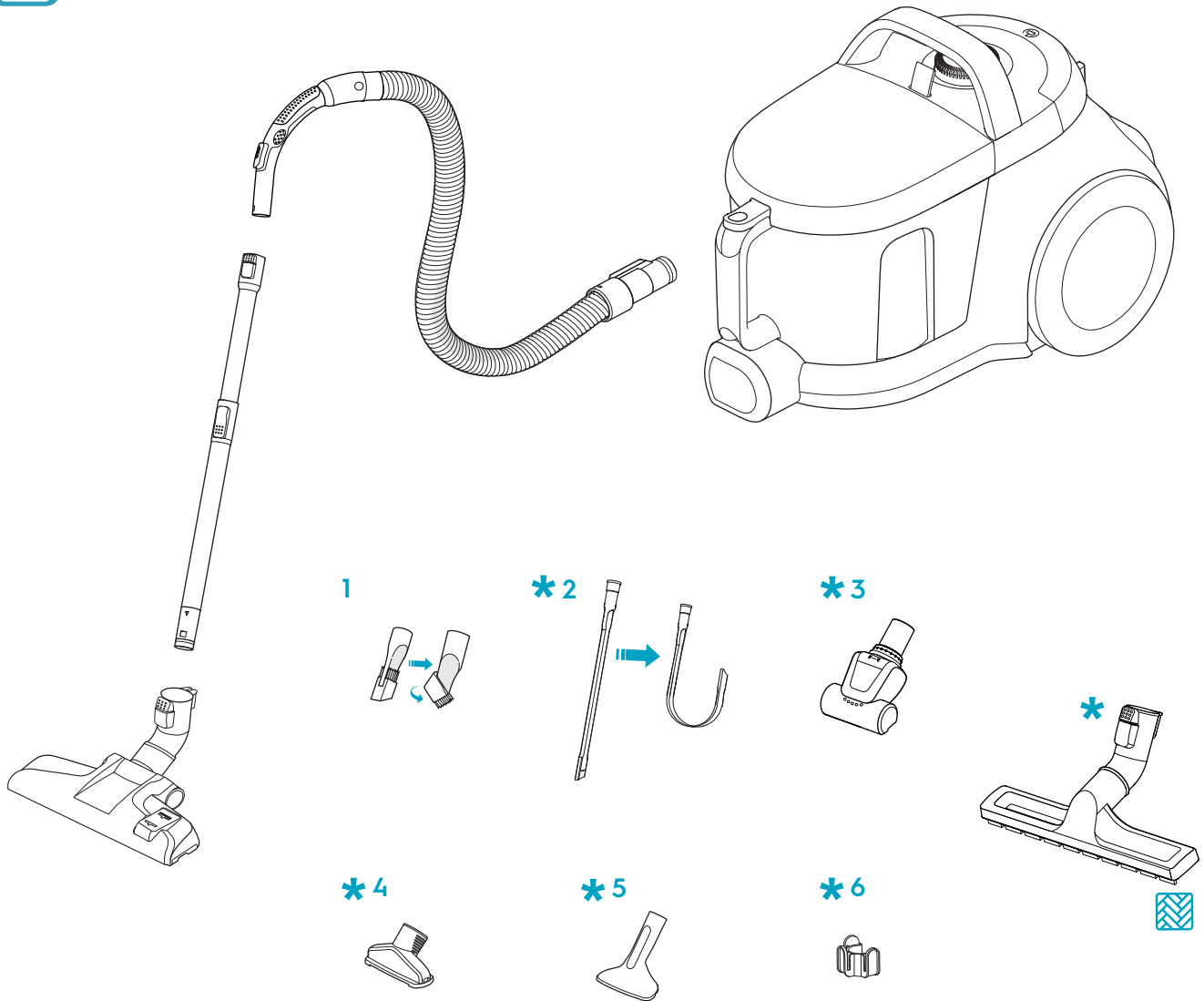

* Accessories may vary from model to model. | 액세서리는 모델마다 다를 수 있습니다. | Phụ kiện có thể khác nhau giữa các kiểu máy.
 Aksesori mungkin berbeza dari model ke model. | อุปกรณ์เสริมอาจแตกต่างกันในแต่ละรุ่น | Les accessoires peuvent varier d'un modèle à l'autre. |
 قد تختلف الملحقات بحسب النموذج



Carpet



Hard Floor



Power adjustment

www.electrolux.com

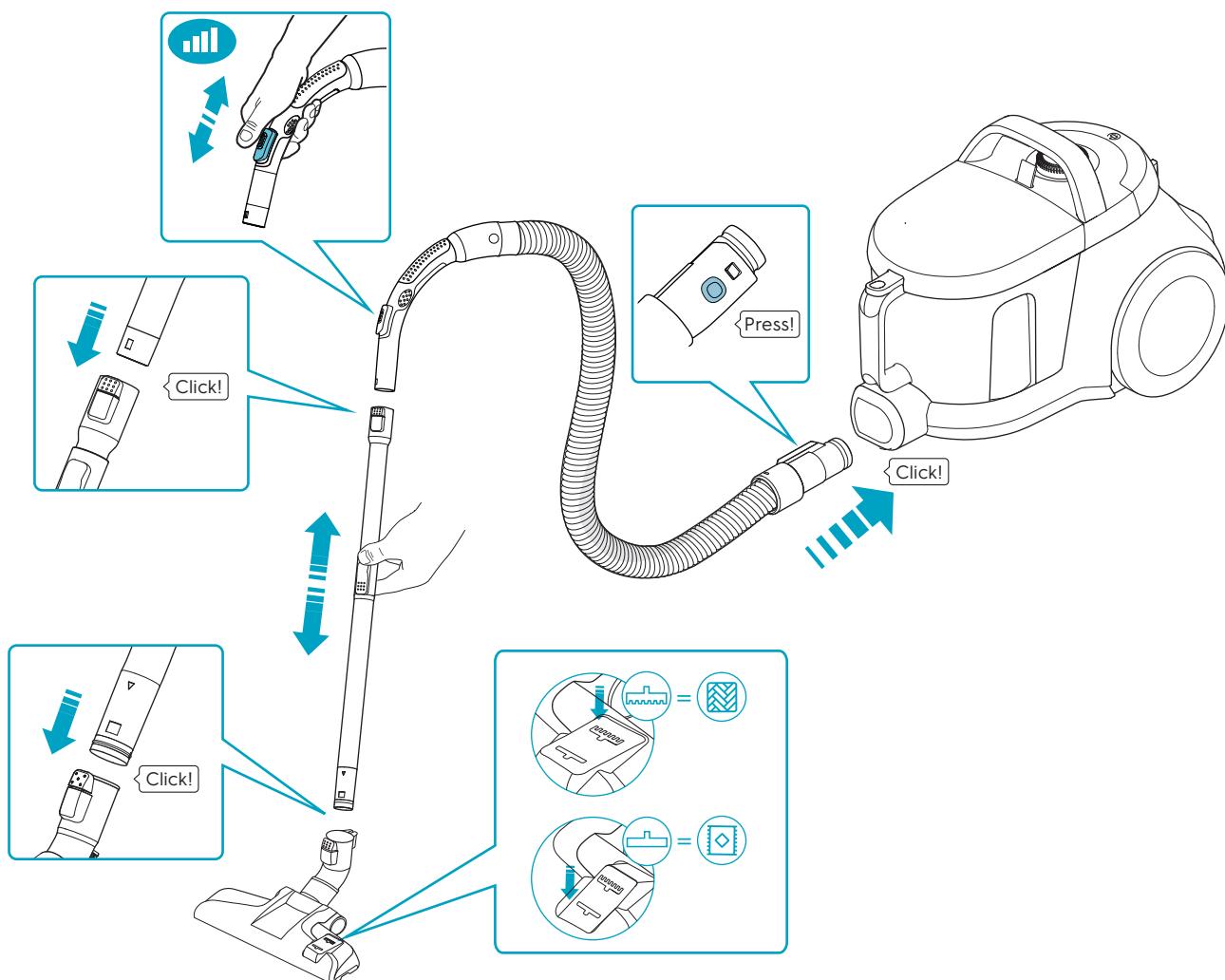

500 Bagless cleaner

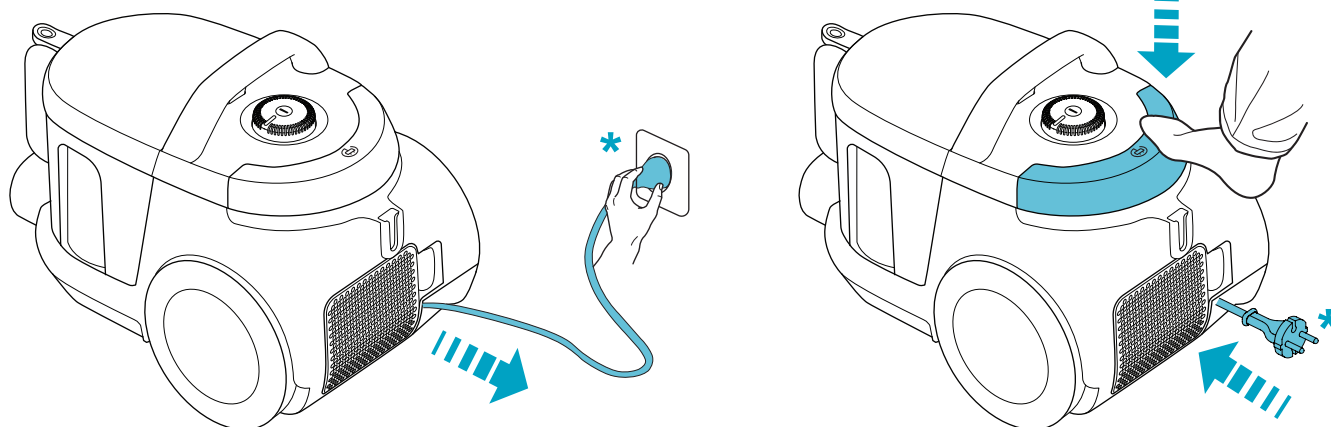

* Plug types may vary from model to model.

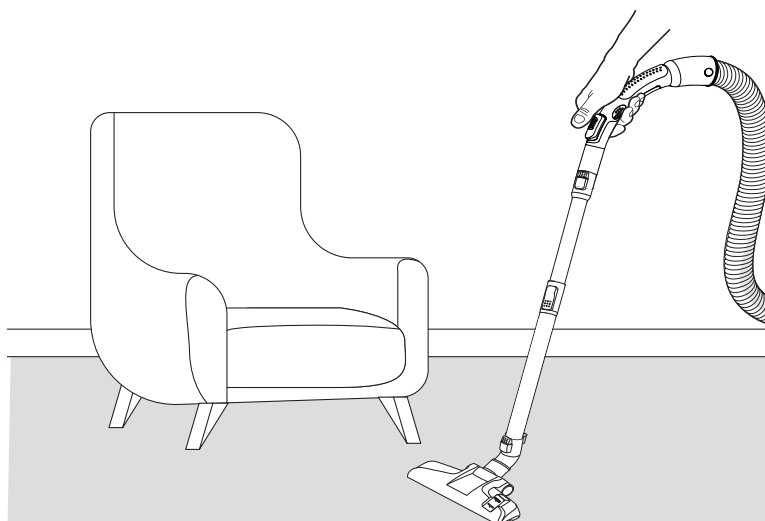
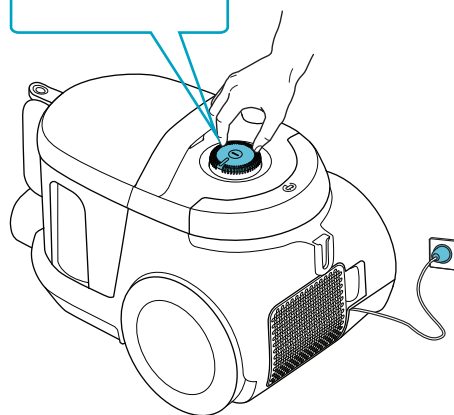
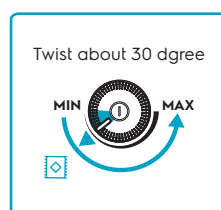
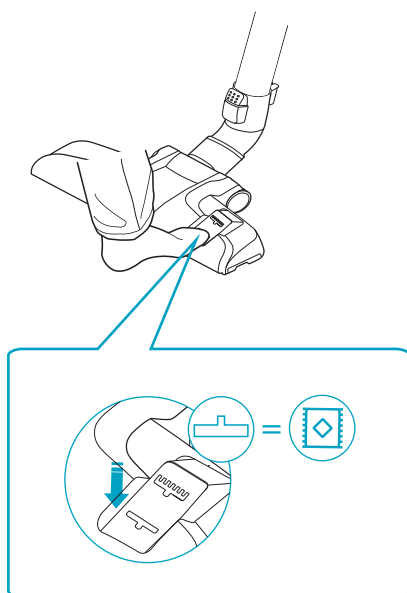
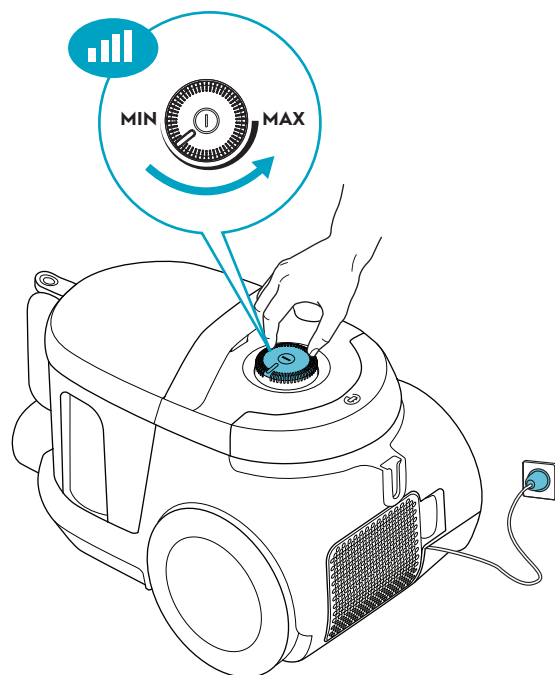
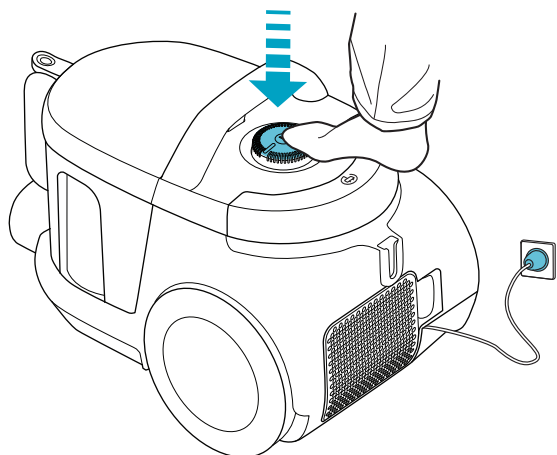

P

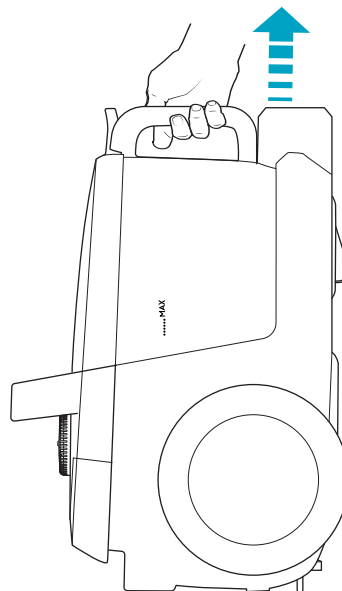
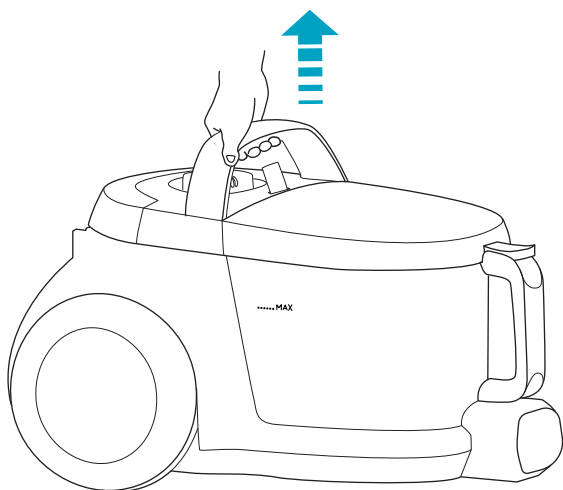

P

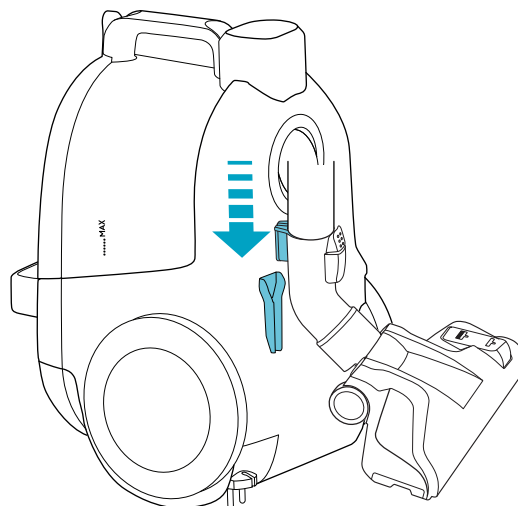
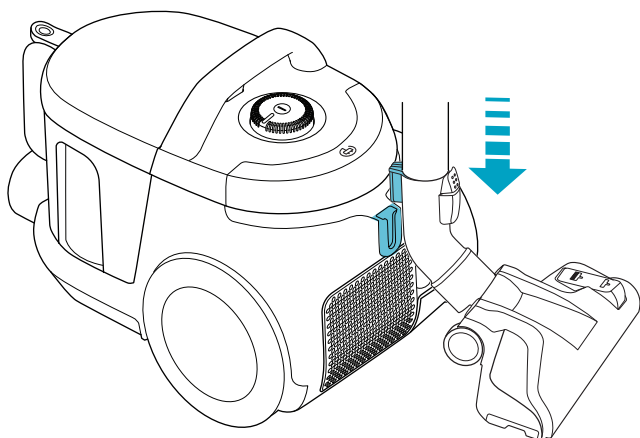

↻

2M  Max 40°C

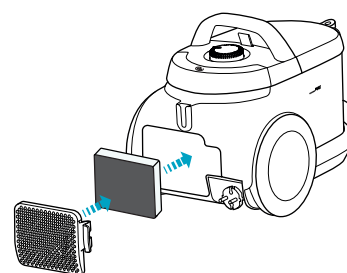
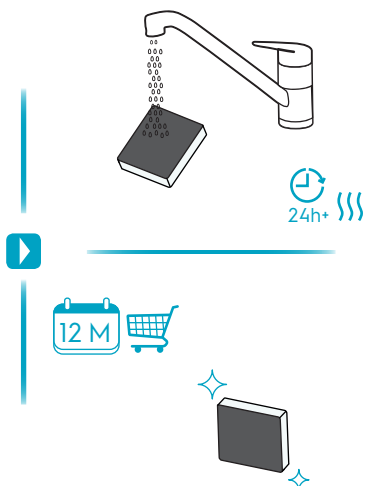
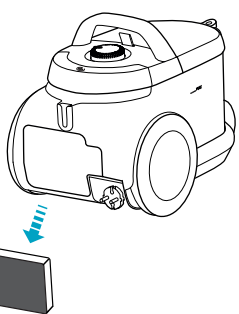
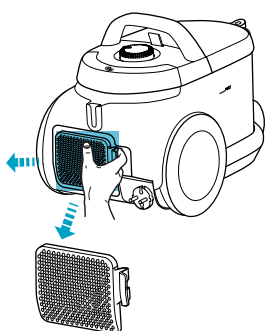

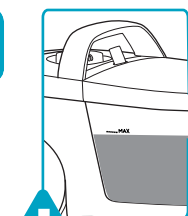

Max

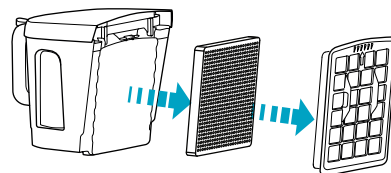
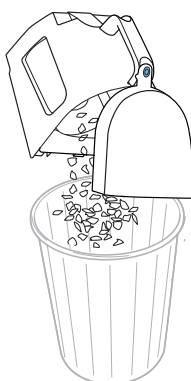
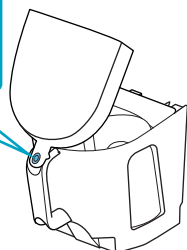
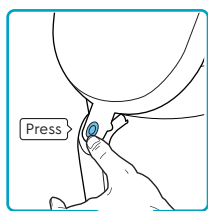
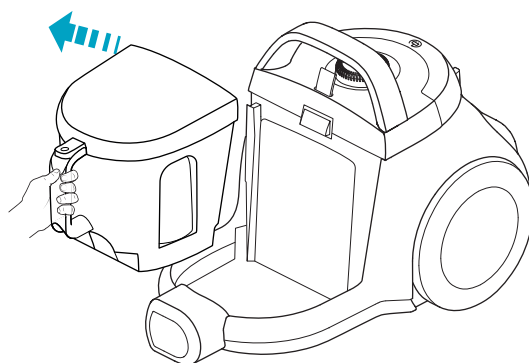
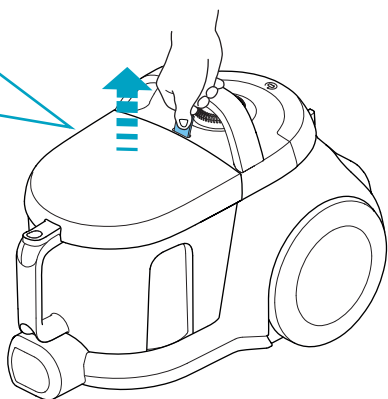

Max 40°C

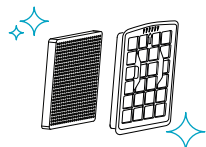
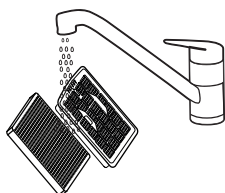

Max 40°C

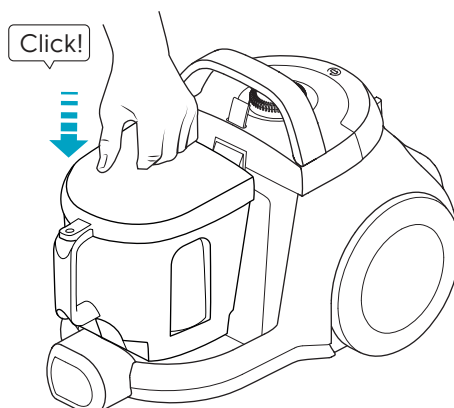
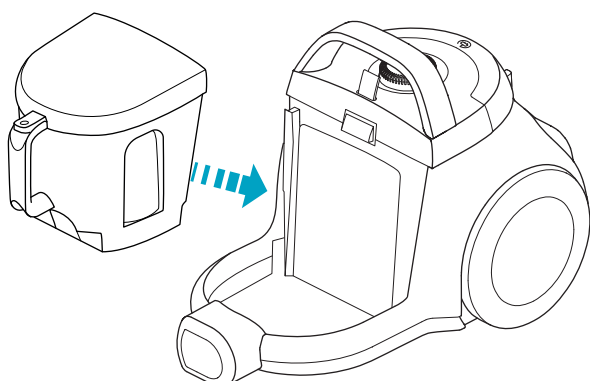
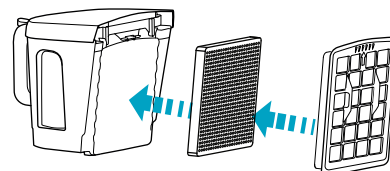
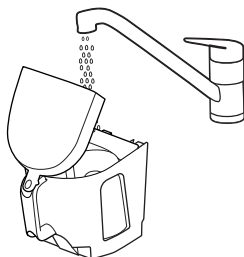

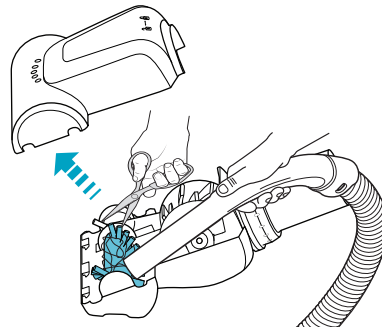
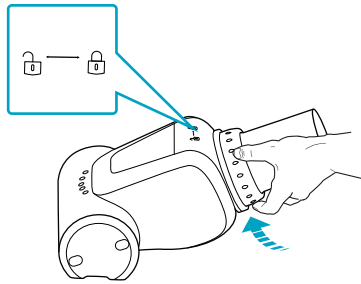
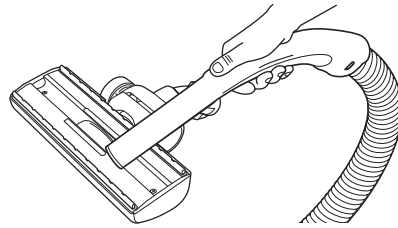
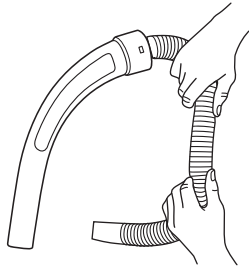

www.shop.electrolux.com

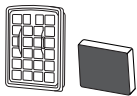

ESKW9

900 923 828

Performance Filter Kit

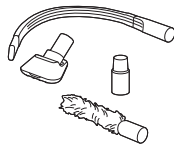

KIT09C

900 923 349

Home and Car Kit

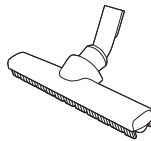

ZE161

900 923 558

Extra Wide Nozzle

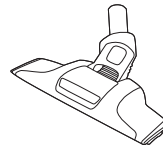

ZE165

900 168 381

Speedy Clean Nozzle



ZE060.1

900 168 381

Textile Turbo

The availability of spare parts may vary from country to country. | 부품 구매 가능 여부는 나라에 따라 다를 수 있습니다. |
Các linh kiện thêm có thể khác nhau tùy theo quốc gia. | Ketersediaan suku cadang dapat bervariasi dari satu negara ke negara lain. |
อะไหล่ที่จำหน่ายอาจแตกต่างกันไปในแต่ละประเทศ

Problem	Solution
The vacuum cleaner does not start	<ul style="list-style-type: none"> • Check that the cable is connected to the mains. • Check that the plug and cable are not damaged. • Check for a blown fuse.
The cleaner shots	The cleaner might be overheated: disconnect it from the mains; check if the nozzle, tube, hose or filters are blocked. Let the cleaner cool down for 30 minutes before plugging it in again. If the cleaner still does not work, contact and authorized Electrolux service centre.
Reduced suction capacity	<ul style="list-style-type: none"> • Check if the dust container is full or blocked. • Check if the nozzle, tube hose or filters are blocked. • Check if the dust container and filters are in place. Clean or replace the filter. If the hose is damaged it will be necessary to replace it.
Clearing the hose	<p>Clear the hose by "squeezing" it. However, be careful in case the obstruction has been caused by glass or needles caught inside the hose.</p> <p>Note: The warranty does not cover any damage to the hose caused by cleaning it.</p>
The vacuum cleaner is overheated	<ul style="list-style-type: none"> • Check if the dust container is full or blocked. Empty the dust container. • Clean or replace the filter.
Water has been sucked into the vacuum cleaner	It will be necessary to replace the motor at an authorized Electrolux service centre. Damage to the motor caused by the penetration of water is not covered by the warranty
For any further problems, contact an authorized Electrolux service centre.	